

PROPOSED TRANSPORTABLE DWELLING
AT: 1a WORTH STREET,
YASS NSW 2582
FOR: BEN NORCOTT

SEDIMENT & EROSION CONTROL:

OBSERVATIONS:

- * SITE HAS APPROX 30mm FALL ACROSS THE BUILDING PAD.
- * NO SITE CUT OR FILL IS REQUIRED FOR THE NEW DWELLING

MEASURES REQUIRED:

PROVIDE AN OH&S APPROVED FENCE TO PREVENT UN-AUTHORISED SITE ACCESS DURING CONSTRUCTION

PROVIDE COUNCIL APPROVED SEDIMENT FENCE AS REQUIRED.

NO OTHER SEDIMENT & EROSION CONTROL MEASURES SHOULD BE NECESSARY OVER THE SITE DURING THE DEVELOPMENT

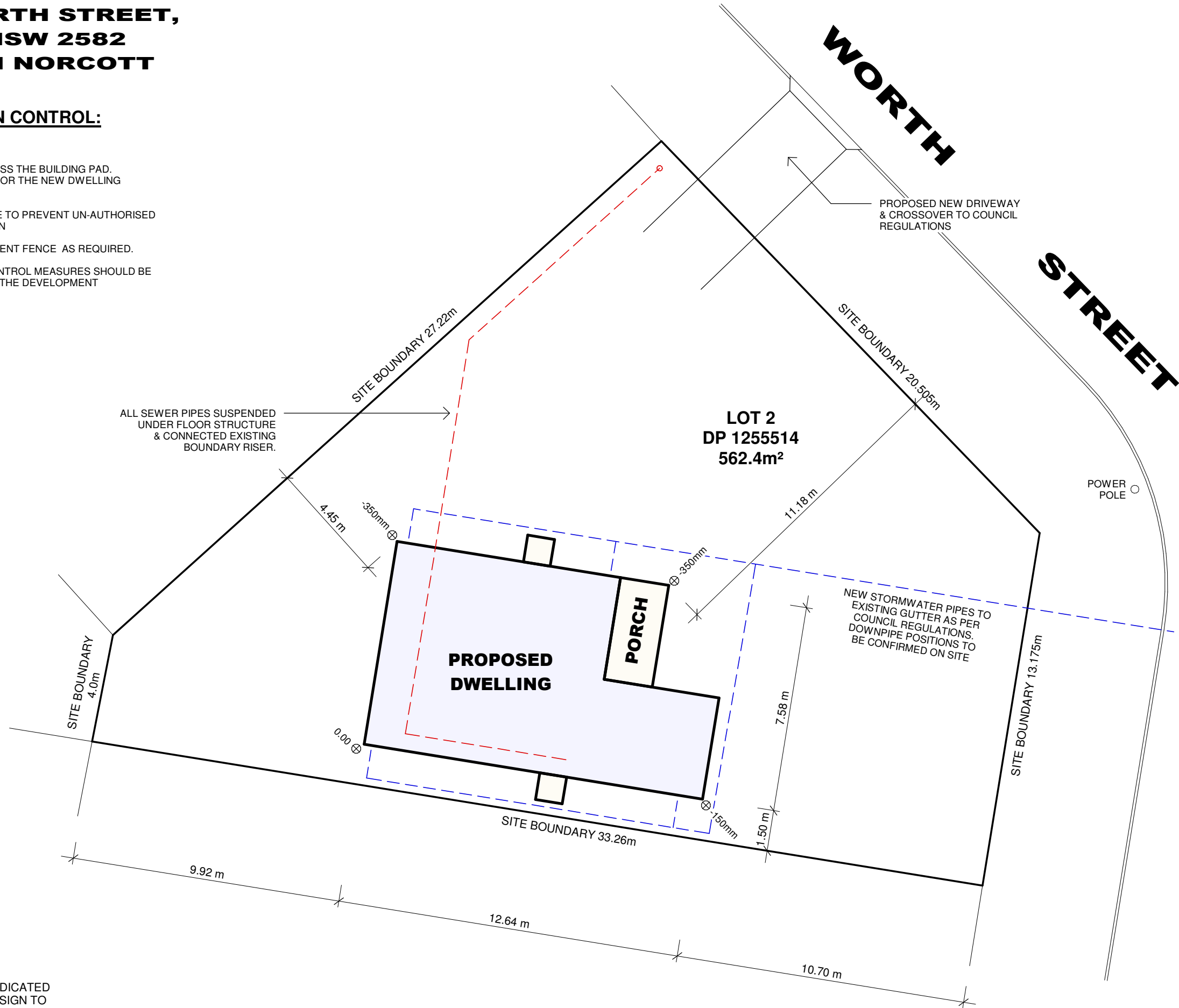

NOTE:
 STORMWATER & SEWER PIPE INDICATED
 ARE INDICATIVE ONLY. FINAL DESIGN TO
 PLUMBERS DETAILS

SITE PLAN - 1:150

Sheet **A01**

Date 15-05-24

24-31

**PROPOSED DWELLING,
 FOR: BEN NORCOTT
 AT: 1a WORTH STREET,
 YASS NSW 2582**

SHEET A3

Drawn By **C.K.**

Checked By **C.K.**



CK Design & Drafting

Trading as CK Design & Drafting Pty, Ltd.
 ABN 88 664 679 341
 ACN 664 679 341

53 Inglis Street,
 Wagga Wagga NSW 2650
 Mb: 044783625
 Email: chris@ckdrafting.com.au